

SUMMERHILL OFFICE PARK

VICTORIA ROAD, DOUGLAS

Units 1,2,3 & 4

TO LET:

Self contained buildings of 3,000 & 6,000 sq ft



Michael
CHAPMAN
& COMPANY

Chartered Surveyors

01624 623127

info@chapman.im

www.chapman.im

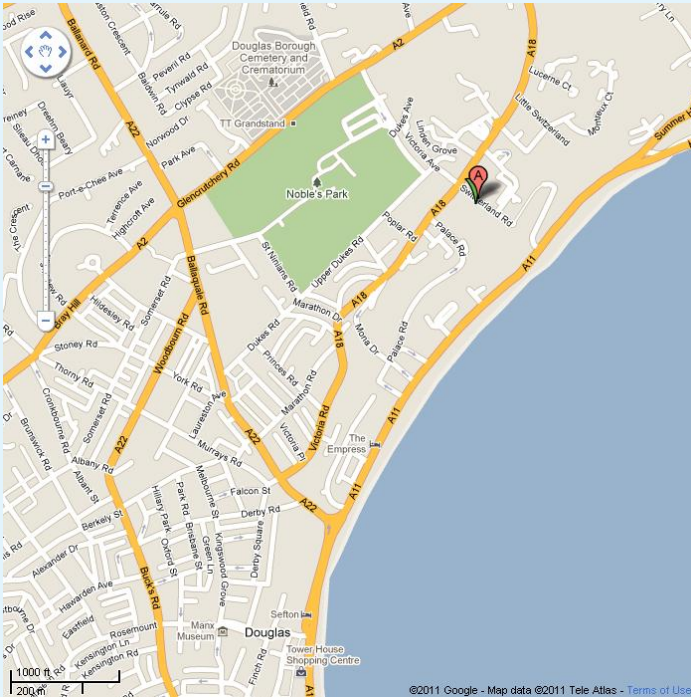

LOCATION

Summerhill Office Park is located around one mile from Douglas town centre and is set in landscaped parkland. It is the Island’s only edge of town scheme which is reserved solely for offices. Existing occupiers include Royal Bank of Scotland International and Scottish Widows.

The next phase of development comprises the construction of four self contained office buildings which will be situated along the boundary with Victoria Road.

SPECIFICATION

The buildings will be finished to a high standard to include raised access floors and comfort cooling. Each unit will be clad externally in painted smooth render with Manx stone panels and will have a double height glazed atrium entrance.

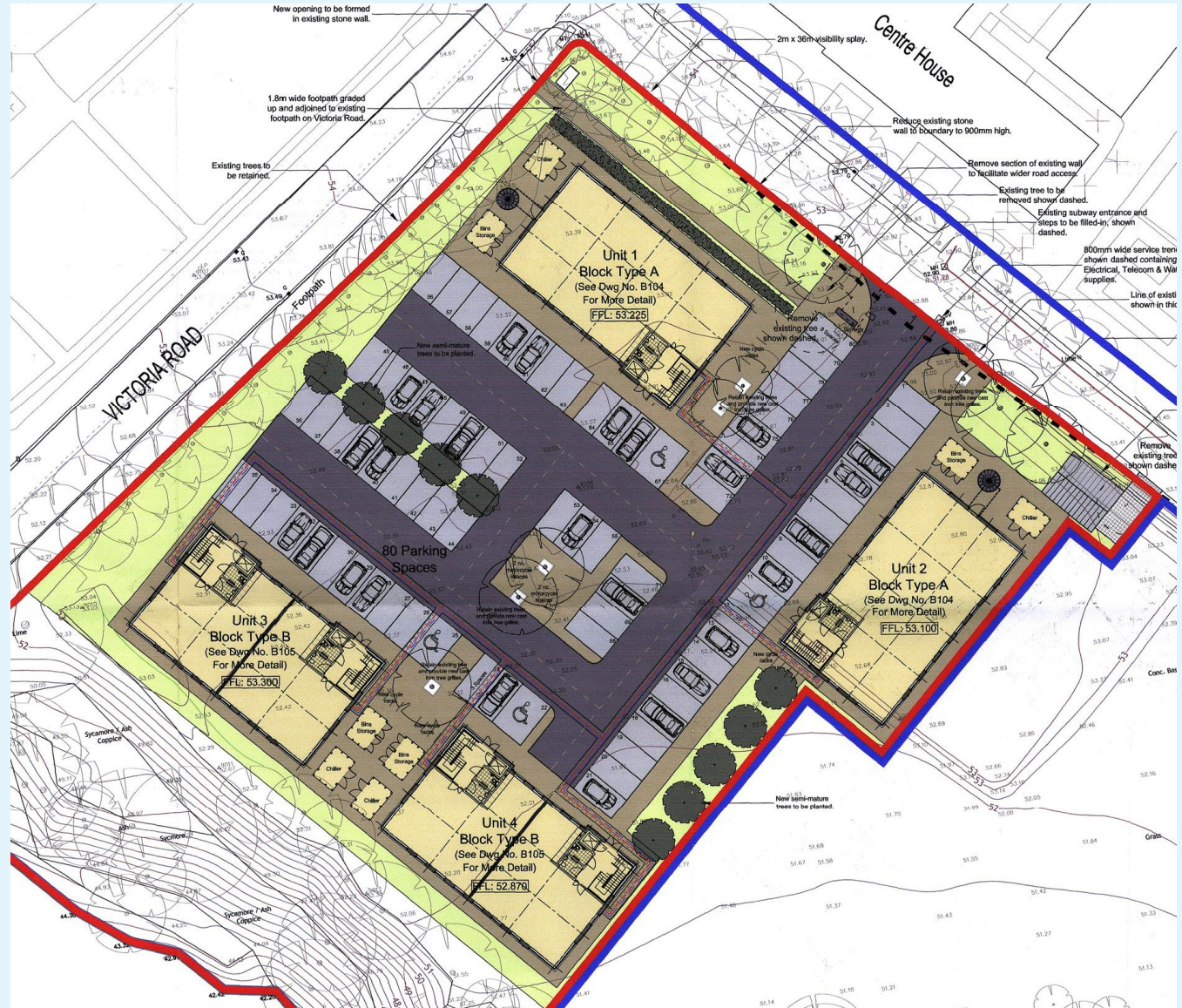

ACCOMMODATION & CAR PARKING

Unit 1	6,000 sq ft	20 car parking spaces min
Unit 2	6,000 sq ft	20 car parking spaces min
Unit 3	3,000 sq ft + 3,000 sq ft	20 car parking spaces min
Unit 4	3,000 sq ft + 3,000 sq ft	20 car parking spaces min

Terms available on application